

# Fuel Moto

## 2006 Harley Davidson Dyna Installation Instructions

### Parts List

- 1 EFI Tuner
- 2 O2 eliminators
- 1 USB Cable
- 1 CD-ROM
- 1 Installation Guide
- 1 Power Adapter
- 2 Velcro Strip
- 1 Alcohol Swab



**The ignition MUST be turned OFF before installation!**

You can also download the Power Commander software and latest maps from the Dynojet® web site at:  
[www.powercommander.com](http://www.powercommander.com)

**PLEASE READ ALL DIRECTIONS BEFORE STARTING INSTALLATION**

Fuel Moto 2215 Kelbe Drive Little Chute, WI 54140 (877) 729-4754 [www.fuelmotousa.com](http://www.fuelmotousa.com)



- 1 Remove the seat
- 2 Remove the left hand side cover (Fig. A).

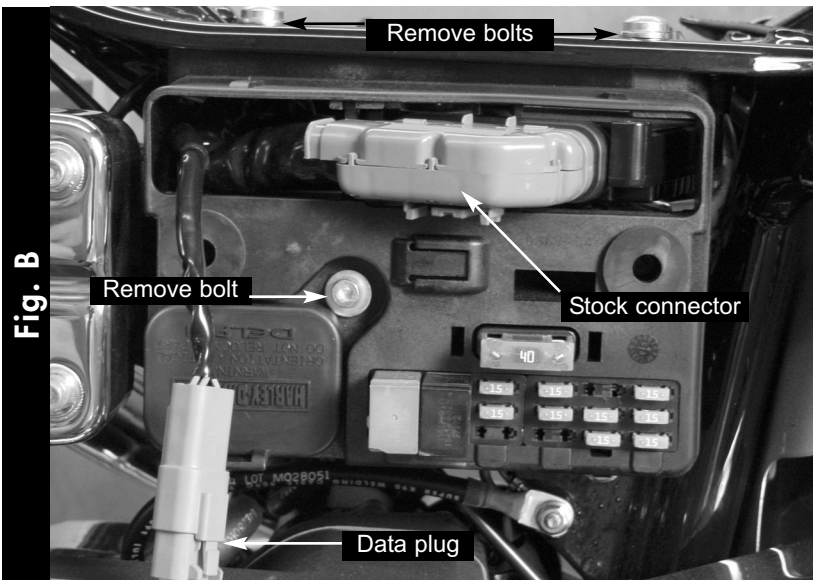

- 3 Unplug the stock wiring harness connector from the ECM (Fig. B).
- 4 Move the data plug (Fig. B) out of the way to access bolt.
- 5 Remove the 3 bolts that hold the electrical box in place (Fig. B).

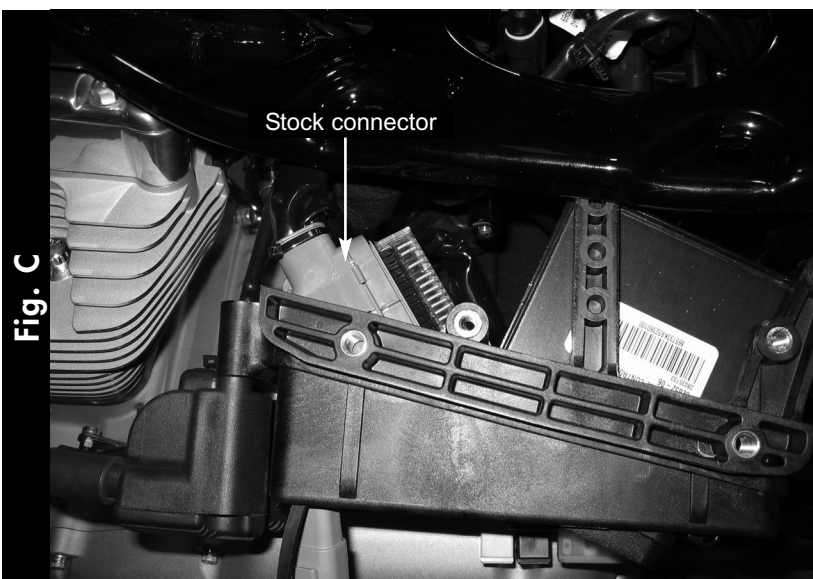

- 6 Slide the plastic box out from the frame.
- 7 Route the stock connector through to the back side of the electrical box (Fig. C).

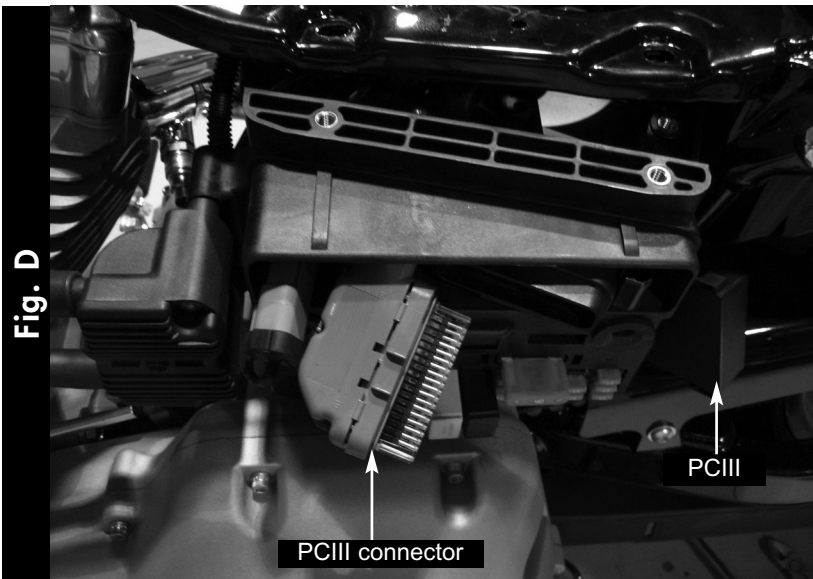

- 8 Lay the PCIII behind the electrical box temporarily.
- 9 Route the GREY connector from the PCIII through the back of the electrical box and plug it into the ECM (Fig. D).

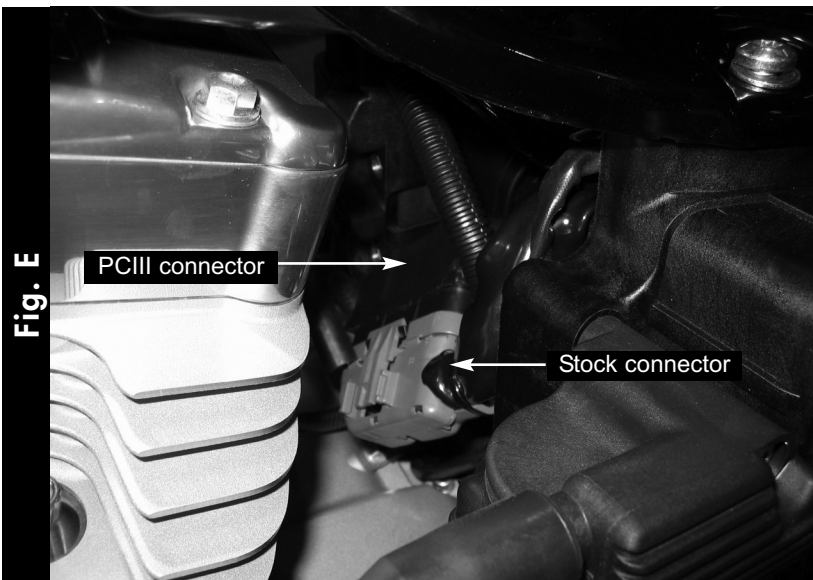

- 10 Connect the stock wiring harness to the BLACK connector of the PCIII.
- 11 Zip tie these connectors to the front side of the electrical box (Fig E). Make sure they are situated away from the rear exhaust pipe.

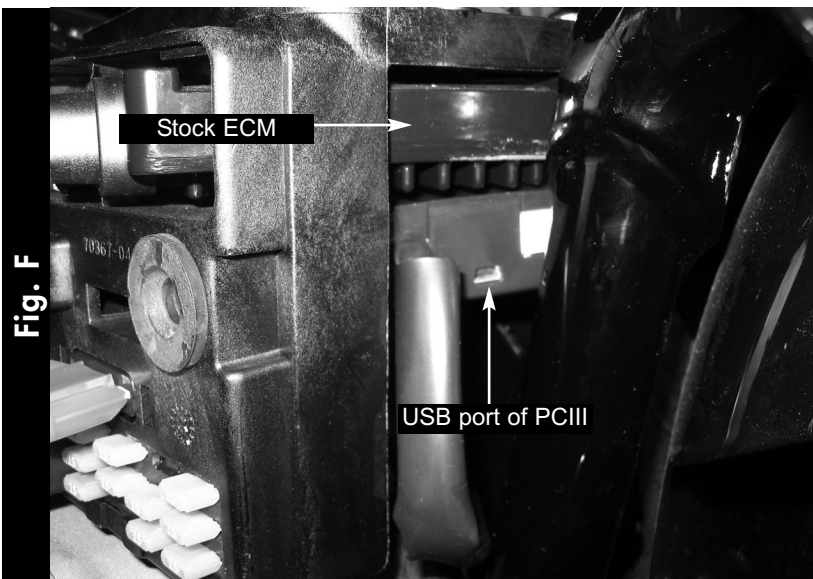

- 12 Mount the PCIII to the underside of the stock ECM (Fig. F) using the supplied velcro. Make sure to clean both surfaces with the alcohol swab before attaching.

Situate the PCIII so the USB and expansion ports point to the rear of the bike. This will allow you easier access to adjust the maps if necessary.

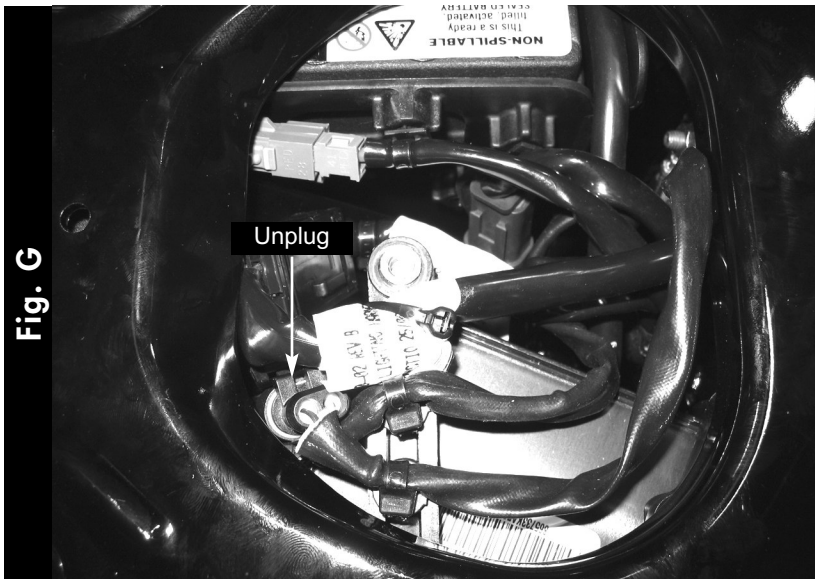

- 13 Unplug the rear O2 sensor from the stock wiring harness (Fig. G). This connector is located in the frame opening below the seat.

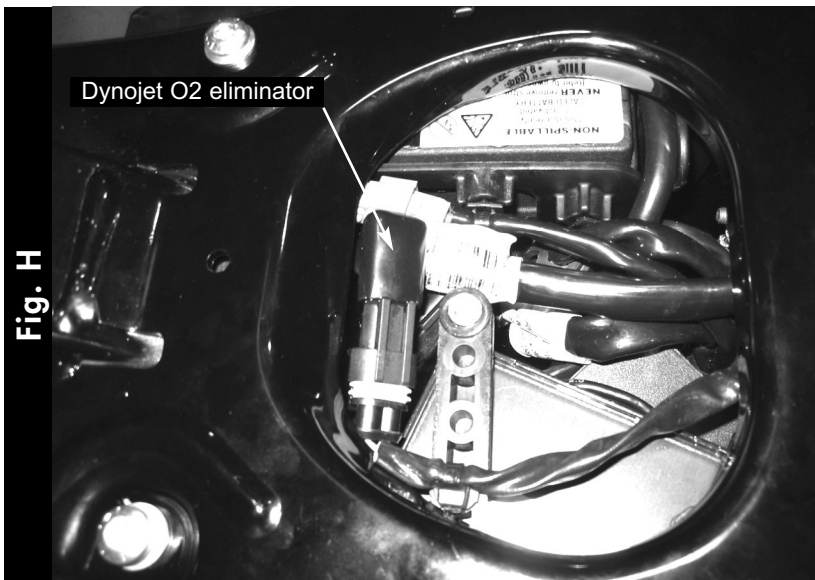

- 14 Plug one of the Dynojet O2 eliminators into the stock wiring harness (Fig. H).



- 15 Unplug the front O2 sensor from the stock wiring harness. This connector is located near the front head pipe.
- 16 Plug the Dynojet O2 sensor eliminator into the stock wiring harness (Fig. J).
- The stock O2 sensors are no longer needed. If you leave them installed into the exhaust pipes make sure the wires will not come into contact with the exhaust.
- 17 Reinstall the electrical box using the stock bolts.